

NOWLEY SMART

21-2302
Instruction manual

◆ Appearance Description

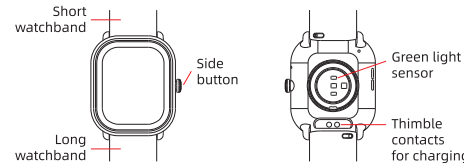

◆ Schematic Diagram of Charging

Operate in strict accordance with the following figures:

1. Please use the product-specific magnetic charging cable to charge by aligning it with the charging contacts on the back of the watch.
2. Do not use a power adapter with a voltage exceeding 5V and an output current exceeding 1A for charging, as this may cause charging failure and damage to the magnetic charging cable or the device.
3. Please activate the watch when it runs out of power before charging: the watch screen will only light up after about 5 minutes of normal charging.

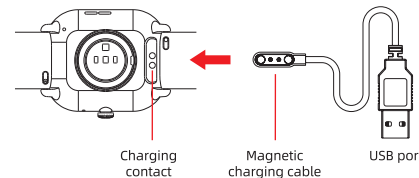

◆ Introduction to Watch Function

- ①、Brightness adjustment
- ②、Time display
- ③、Music control
- ④、Don't disturb the switch
- ⑤、Flashlight
- ⑥、Talk bluetooth switch
- ⑦、Settings
- ⑧、Version information
- ⑨、Finding your phone
- ⑩、Split screen function



Main interface: Display the current time, date, steps and other information of the watch; press the main interface for a long time to switch the main dial left and right, and click to confirm.

Watch audio switch: It can turn on/off the watch call function and multimedia sound playback function.

Steps: Display current steps, distance and calories of the watch.

Heart rate: Slide to this page and keep a while and automatically measure the current real-time dynamic heart rate. Connectable to APP to set real-time monitoring and view data records.

Blood pressure: Slide to this page and keep a while and automatically measure the current blood pressure data and vibrate to indicate the result. Connect the APP to view the watch offline measurement data or online measurement synchronously.

Blood oxygen: Slide to this page and keep a while and automatically measure the current blood oxygen data and vibrate to indicate the result.

Exercise: Click on the icon on this page to access the multiple sport modes option. Select a sport mode, click the icon to start, and slide right to pause or stop the sport.

Sleep: The bracelet can record and display your sleeping time last night, and the time of deep sleep and light sleep. More detailed data can be viewed synchronously in the APP.

Weather: Display the local weather conditions. Connect the synchronization APP for normal use, and open the phone GPS to ensure that the APP gets the positioning permission function and network connection.

Message: The watch can receive cell phone calls, SMS, QQ, WeChat and other notification alerts, which can be set according to the message alert and turn on the corresponding push switch on the APP. This page can store up to 8 message records. This function needs to stay connected with the phone and make sure the APP gets the corresponding permission.

Music: After connecting the APP, the watch can control the mobile phone player to play/pause/switch to the previous song and the next song. This function must be opened on the mobile phone player before it can be controlled on the watch. This function requires staying connected to your phone and turning on the notification push permission.

Stopwatch: Click on the icon to start the function, and click Start for timing, pause or reset. Slide right to leave.

Search: Click this icon, your phone will beep to indicate the orientation of your phone, this function requires your phone to stay connected with the watch APP. No alert on the phone in silent mode.

Settings: Click the icon to enter the function, you can set the menu style, screen display, language, time, restore factory Settings and view the watch and other information.

◆ Watch APP Installation and Connection Instructions

As a Bluetooth product, most of the functions of this product need to be connected to a special APP for normal use, such as time display, call alert, and message alert. For Android phones, please do not use Bluetooth to connect and pair with the watch directly. Please scan the following QR code to select the version suitable for your mobile phone system or enter main application markets to download and install FitCloudPro.



◆ Device Connection

Before using the APP, please turn on the mobile phone Bluetooth and mobile phone GPS positioning to obtain the mobile phone positioning permission. After the connection is successful, it will prompt "To pair with: NWS4", please select pairing.

The watch connection operates as follows:

Open the APP and make settings according to the prompt

Click [Select Device] to search

Select the name of the searched Bluetooth: P1015

Connection succeeded

Note:

1. For Android users, the APP should obtain permissions and run backstage, otherwise it will affect the user experience.
2. For systems below iPhone iOS 13, after connecting in the APP, you need to connect to the P1015 for the second time in the Bluetooth settings of the mobile phone, and then you can make calls, play multimedia music and other functions.

◆ Precautions

- 1 The following conditions are not covered by the warranty:
 - A. Accident or harm
 - B. Testing, repairing or disassembling without authorization
 - C. Contamination due to human reasons
 - D. Damage caused by connection with a non compatible equipment
 - E. Natural aging
 - F. Damage caused by Force majeure
 - G. Shock or impact
- 2 Please avoid strong magnetic field, direct light or high temperature environment.
- 3 This product is not intended for disease diagnosis, treatment or prevention. Only a qualified doctor can diagnose and treat any health disease.
- 4 It could happen that the data given by the smartwatch is not accurate, due to external factors, such as the physical condition or weather conditions.
- 5 Please avoid wearing the watch strap too tightly, and keep the contact area between the watch and your skin clean.
- 6 Children should use this product under the guidance of their parents to avoid harm.
- 7 The waterproof rating of this product is IP68, so avoid being immersed in water neither put it under the water.